

AHR-F2N7(A)-2.8(O)

AHD3.0 OUTDOOR CAMERA



Main Features

- 1/2.8" Sony 2.0μm Pixel Progressive Starvis Color CMOS Sensor
- Approx. 5.11 Mega Pixels (Max. 1944p)
- Manual Fixed Lens (f=2.8mm)
- WDR / 3D-DNR / DSS (Sense-up) Supported
- Audio Microphone Available (Option)
- AHD3.0 Camera (Universal Analog HD Video Formats)
- UTC Supported
- Water-proof Housing (IP66)



Dimension

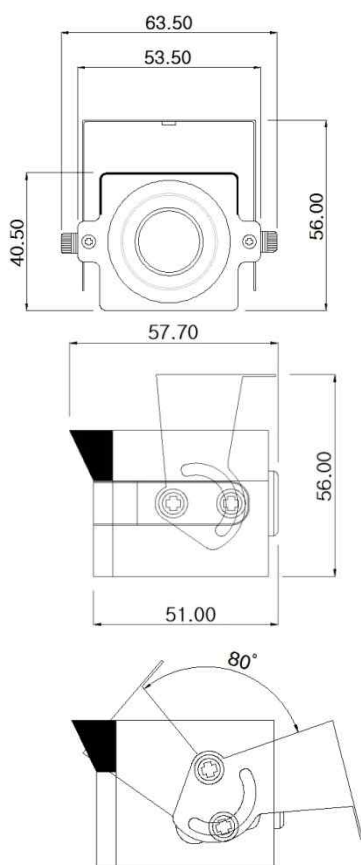

Option

- Lens(Fixed)
f=3.3, 3.6, 4, 6, 8, 12, 16, 25mm
- Wall-mount Bracket
- AHR-F2N7A-2.8(O) : Audio Built-in

Specifications

Model	AHR-F2N7-2.8	AHR-F2N7-2.8O
Signal System	AHD 3.0	
Pickup Device	1/2.8"(D-6.52mm) 5.11M Sony CMOS Sensor	
Scanning System	Progressive Scan (5MP Mode - 4:3, 4MP Mode - 16:9)	
Sync. System	Internal	
Total Pixels	5.69MP [2704(H)x2104(V)]	
Active Pixels	5.11MP [2608(H)x1960(V)]	
Min. Illumination	0.01Lux(F2.5 - 30IRE), 0.003Lux (DSS on)	
No. of IRED	N/A	
Video Out (BNC)	AHD3.0: 2592x1944p(4:3)@Max.20 2560x1440p, 1920x1080, 1280x720(16:9)@25/30	
Lens	Fixed f=2.8mm, F2.5	
Lens (Mount)	Board type (M12)	
Angle of View	5MP 4:3 Mode: 122.5°(D), 95°(H), 69°(V) 2/4MP 16:9 Mode: 112.5°(D), 95°(H), 51.5°(V)	
OSD	UTC	Via OSD Cable & UTC
Camera Title	Off, On(Max. 8 Characters)	
Language	English, Chinese(Simplified), Chinese(Traditional), Japanese, Korean	
Exposure	AE, Manual	
White Balance	AUTO, AUTOext, Preset, Manual	
BLC	Off, HLC, BLC, WDR	
Day & Night Mode	AUTO, COLOR, B/W, IR_EXT	
Gain Control	AGC (0~10)	
Electronic Shutter	Auto, Manual, Flickerless 1/25(30)~1/25,600(30,000)	
DSS(Sense-up)	X32	
Noise Reduction	3DNR (High, Middle, Low)	
Mirror	Off, On(Mirror, Flip, Rotation)	
Other Features	Motion Detection (4 Zones), Privacy Mask (16 Zones), ACE, D-Zoom, Defog, Gamma, Shading etc.	
Microphone(Optional)	AHR-F2N7A-2.8	AHR-F2N7A-2.8O
Power Source	DC 12V	
Power Consumption	Less than 2.5 Watts (120mA@DC12V)	
Operating Temp.	-10°C ~55°C (Humidity :0%RH ~ 90%RH)	
Size (mm)	63.5(W) x 40.5(H) x 57.7(D) (Without Bracket)	
Weight	242g (gift-box packing)	260g (gift-box packing)

Cable Connection Interface

AHR-F2N7-2.8

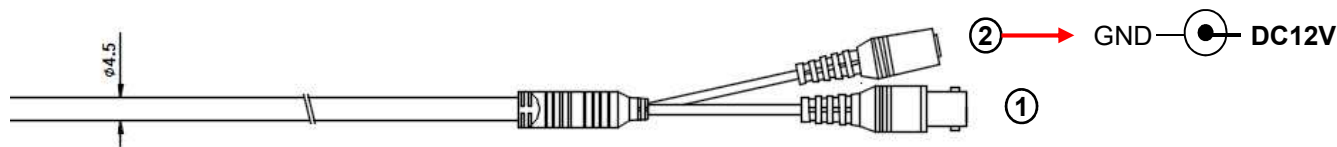

AHR-F2N7-2.80

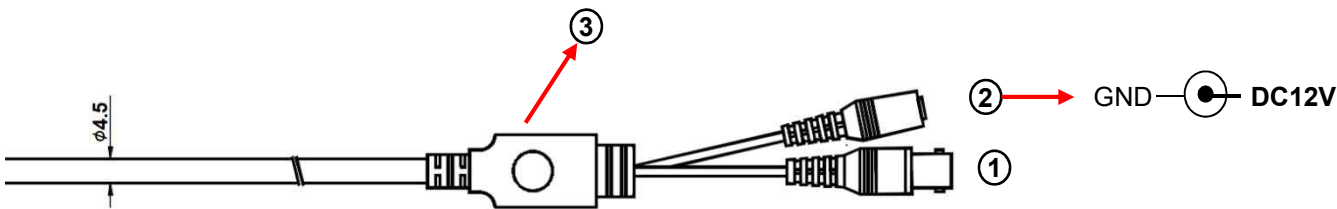

	Function		Function
①	BNC – AHD Analog Out	②	DC 3.5phi – DC Power In
③	Cable OSD Joystick		

SETUP MENU	SUB MENU 1	SUB MENU 2	SUB MENU 3	VALUE
EXPOSURE	BRIGHTNESS			0 ~ 20 (12)
	SHUTTER	AUTO		NORMAL / DEBLUR
		MANUAL		NTSC : 1/30 ,60,120,250,500,1K,2K,4K,8K,15K,30K PAL : 1/25 ,50,100,200,400,800,1.6K,3.2K,6.4K,12.8K,25.6K
		FLICKER		
	SENS-UP			OFF / X2/ X4/ X8 / X16 / X32
	AGC			0 ~ 10 (8)
BACKLIGHT	OFF			
	HLC	LEVEL		0 ~ 20 (10)
		COLOR		BLK / WHT/ YEL/ CYN/ GRN/ MAG/ RED/ BLU
	BLC	H-POS		0 ~ 20 (8)
		V-POS		0 ~ 20 (10)
		H-SIZE		0 ~ 20 (10)
		V-SIZE		0 ~ 20 (10)
	WDR	WEIGHT		LOW/ MIDDLE / HIGH
DAY&NIGHT	AUTO	D>N THRES		0(bright) ~ 20(dark) (13)
		N>D THRES		0(bright) ~ 20(dark) (7)
		DELAY		0 ~ 9sec/ 10sec/ 15sec (0 Sec)
		BURST		OFF/ ON
	COLOR			
	B&W	BURST		OFF/ ON
WHITE BAL	AWB	AUTO		
		AUTOext		
		PRESET		Press ENTER key
		MANUAL	C-TEMP.	3000K/ 5000K / 8000K
			R-GAIN	0 ~ 20 (10)
			B-GAIN	0 ~ 20 (10)
	COLOR GAIN			0 ~ 20 (10)
DNR				OFF/ LOW/ MIDDLE / HIGH
IMAGE	SHARPNESS			0 ~ 10 (8)
	GAMMA			0.45/ 0.55 / 0.65/ 0.75
	MIRROR			OFF / ON
	FLIP			OFF / ON
	D-ZOOM			1.0X~16.0X (1.0X)
	ACE			OFF / LOW/ MIDDLE/ HIGH
	DEFOG	OFF		
		ON	MODE	AUTO / MANUAL
			LEVEL	LOW/ MIDDLE / HIGH
	SHADING	OFF		
		ON	WEIGHT	0~100% (100%)

SETUP MENU	SUB MENU 1	SUB MENU 2	SUB MENU 3	VALUE
IMAGE	PRIVACY	BOX	OFF/ON	
			ZONE NUM	0 ~ 15
			ZONE DISP	OFF/ ON
			H-POS	0 ~ 60
			V-POS	0 ~ 34
			H-SIZE	0 ~ 60
			V-SIZE	0 ~ 34
			Y LEVEL	0 ~ 20
			CB LEVEL	0 ~ 20
			CR LEVEL	0 ~ 20
			TRANS	0 ~ 3
		POLYGON	OFF/ON	
			ZONE NUM	0 ~ 7
			ZONE DISP	OFF/ ON
			POS0-X~POS3-X	0 ~ 120
			POS0-Y~POS3-Y	0 ~ 68
			Y LEVEL	0 ~ 20
			CB LEVEL	0 ~ 20
			CR LEVEL	0 ~ 20
			TRANS	0 ~ 3
MOTION	OFF			
	ON	DET WINDOW	WINDOW USE	0 ~ 3
			WINDOW ZONE	OFF/ ON
			DET H-POS	0 ~ 60
			DET V-POS	0 ~ 34
			DET H-SIZE	0 ~ 60
			DET V-SIZE	0 ~ 34
		SENSITIVITY		0 ~ 10 (5)
		MOTION OSD		OFF/ ON
		TEXT ALARM		OFF/ ON
SYSTEM	COMM	CAM ID		0 ~ 255 (1)
		BAUDRATE		2400/ 4800/ 9600/ 19200/ 38400/ 57600/ 115200
		CAM ID DISPLAY		OFF/ ON
	OUTPUT	FRAME RATE	CVBS	720p30(25), 1080p30(25), 1440p30(25), 1944p12.5, 1944p20
			HD_T	720p30(25), 1080p30(25), 1440p30(25), 1944p12.5, 1944p20
			HD_C	720p30(25), 1080p30(25), 1440p30(25)
			HD_A	720p30(25), 1080p30(25), 1440p15, 1440p30(25), 1944p12.5, 1944p20
		FREQ(NT/PAL)		50Hz(PAL) / 60Hz(NTSC)
		ANALOG MODE		OFF / CVBS / HD_T / HD_C / HD_A
		CVBS OUT MODE		CUT / FULL
	LANGUAGE			ENGLISH/ CHINESE(Traditional)/ CHINESE(Simplified)/ JAPANESE/ KOREAN
	CAM TITLE	OFF		
		RIGHT UP		0 ~ 9, A ~ Z, blank
		LEFT DOWN		0 ~ 9, A ~ Z, blank
FACTORY DEFAULT				Reset to factory setting
EXIT				Exit SETUP menu