

DCC-Z1840

CMOS VIDEO ZOOM MODULE



Main Features

- 1/1.8" Sony 2.0μm Color CMOS Image Sensor
- 8.4Mega Pixels – Maximum QFHD(3840x2160p)
- Built-in Auto Focus Zoom Lens: 18x Optical (f=6.8~120mm)
- Built-in IR-Cut(650nm) OLPF
- D-WDR, DSS, 3D-NR Supported
- 1080p Digital Video(LVDS) Out or HDMI(Optional)
- Sony Visca, Pelco-D/P Protocol Compatible



Specifications

Model	DCC-Z1840
Pickup Device	1/1.8"(D-8.86mm) 2.13M Sony Starvis CMOS Sensor
Scanning System	Progressive Scan (16:9)
Sync. System	Internal
Total Pixels	9.17M [3952(H)x2320(V)]
Effective Pixels	8.42M [3864(H)x2180(V)]
Min. Illumination	0.1Lux(25/30p), 0.05Lux (ICR on), 0.006Lux (DSS on)
Mechanical ICR	Built-in
Video Out (TMDS)	3840x2160p@24/30 1080p@25/30/50/60, 1080i@50/60, 720p@25/30/50/60 (0.4mm pitch 30pin Micro-coaxial Connector)
Video Out (HDMI)	Optional
Lens	18x Optical Zoom (f=6.8~120mm, F1.61~F4.13) 12x Digital Zoom = Max. 216x
OSD	Via UART
Camera Title	Off, On(Max. 10 Characters)
Language	English, Russian, French, Spanish, Portuguese, German, Chinese(Simplified)
Exposure	Auto, Manual
White Balance	Auto, ATW, Indoor, Outdoor, Manual, Push
BLC	Off, D-WDR/BLC, HLC
Day & Night Mode	Auto, Day, Night
Gain Control	AGC (0~15)
Electronic Shutter	1/25(30)~1/10,000sec
Noise Reduction	3DNR (Off, Auto, Low, Middle, High)
DSS(Sens-up)	X15
Mirror	Off, On(Mirror, Flip, Rotation)
Other Features	Motion Detection (4 Zones), Privacy Mask (8 Zones), Defog, Gamma, Lens Shading etc.
Communication	RS232C-TTL 3.3~5V / Default: 9600bps (Sony Visca, Pelco-D)
No. of Camera ID	Up to 255
Power Source	DC9V ~ 15V
Power Consumption	Less than 5.2 Watts (430mA)
Operating Temp.	-20℃ ~ 60℃ (Humidity :0%RH ~ 90%RH)
Size (mm)	96.8(W) x 50(H) x 60(D)
Weight	305 g (Giftbox Packing)

Dimension

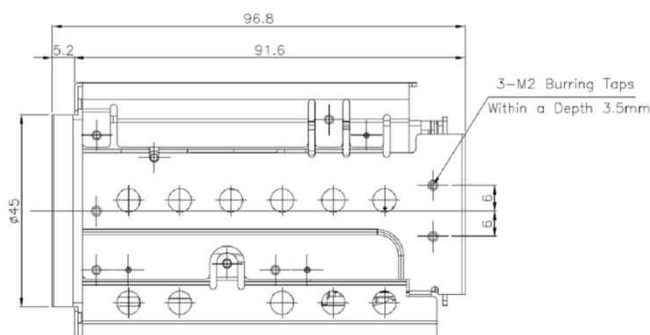
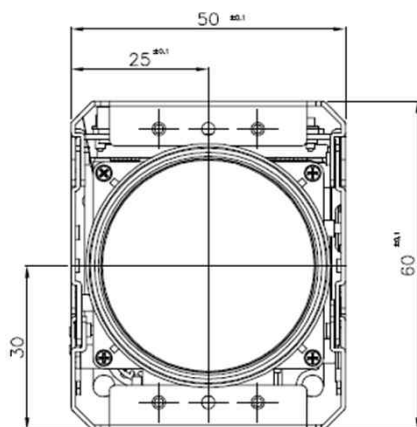

DCC-Z3020

CMOS VIDEO ZOOM MODULE

Pin Connections

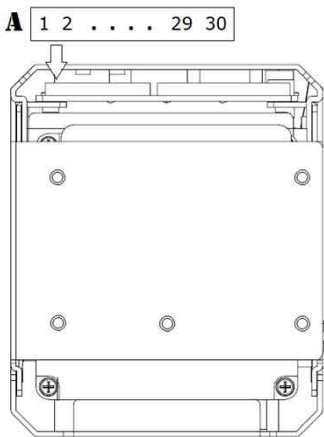

Rear

A – TMDS & Etc.

No.	Pin Item	No.	Pin Item	No.	Pin Item	No.	Pin Item
1	GND	9	TMDS Data 1+	17	Hot Plug Detect	25	TXD (UART 5V output)
2	TMDS Clock -	10	GND	18	DC 5V Output	26	EXT. Reset
3	TMDS Clock +	11	TMDS Data 2-	19	N.C		Reset Low (GND)
4	GND	12	TMDS Data 2+	20	GND		Normal Open (3.3V)
5	TMDS Data 0-	13	GND	21	Key Input	27	DC (9~15V)
6	TMDS Data 0+	14	N.C	22	N.C	28	DC (9~15V)
7	GND	15	N.C	23	GND	29	DC (9~15V)
8	TMDS Data 1-	16	N.C	24	RXD (UART 5V Input)	30	DC (9~15V)

SMD type: **0.4mm pitch – 30 pin Micro-coaxial Cable**

Manufacturer: **KEL**

MFG Part Number: **USL20-30S**