

# AHR-F837-2.8

## AHD2.0 REAR VIEW CAMERA

PARANTEK



### Main Features

- 1/3" 2.75μm 1080p Panasonic CMOS Sensor
- 2 Mega Pixels (1080p 25/30)
- Manual Fixed Lens (f=2.8mm)
- WDR or 3D-DNR, DSS(Sens-up) Supported
- UTC Supported
- AHD2.0 Camera (Universal Analog HD Video Formats)
- Weather-proof Housing (IP66)



### Dimension

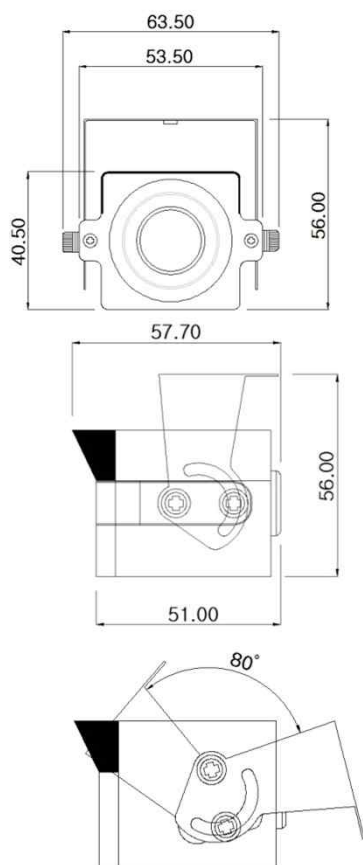

### Option

- Lens
- Wall-mount Bracket
- Cable OSD

### Specifications

Model	AHR-F837-2.8
Signal System	AHD 2.0
Pickup Device	1/3"(D-6.13mm) 2.12M Panasonic CMOS Sensor
Scanning System	Progressive Scan (16:9)
Sync. System	Internal
Total Pixels	2.47MP [1956(H)x1266(V)]
Active Pixels	2.12MP [1944(H)x1092(V)]
Min. Illumination	0.1Lux(F2.5 – 30IRE), 0.003Lux(DSS on)
No. of IRED	N/A
S/N Ratio	More than 50dB (AGC off)
Video Out (BNC)	AHD: 1080p@25/30
Lens	Fixed f=2.8mm, F2.5
Lens (Mount)	Board type (M12)
Angle of View	116°(D), 98° (H), 53°(V)
OSD	Via UTC or Cable OSD(AD port)
Camera Title	Off, On(Max. 8 Characters)
Language	English, Chinese(Simplified), Chinese(Traditional), Japanese, Korean
Exposure	AE, Manual
White Balance	AWB, ATW, Push, Manual
BLC	WDR(Factory Default: ON), Off, BLC, HLC
Day & Night Mode	AUTO, COLOR, B/W, IR_EXT
Gain Control	AGC (0~20)
Electronic Shutter	1/25(30)~1/25,600(30,000)sec
DSS(Sens-up)	Off, On(Max. X32)
Noise Reduction	3DNR (Off when WDR is on)
Mirror	Off, On(Mirror, Flip, Both)
Other Features	Motion Detection (4 Zone), Privacy Mask (16 Zones), Defog etc.
Microphone	N/A
Power Source	DC 12V
Power Consumption	Less than 2 Watts (160mA@DC12V)
Operating Temp.	-10℃ ~ 55℃ (Humidity :0%RH ~ 90%RH)
Size (mm)	63.5(W) x 40.5(H) x 57.7(D) (Without Bracket)
Weight	228g (gift-box packing)

SETUP MENU	SUB MENU1	SUB MENU2	SUB MENU3	SUB MENU4	VALUE
LENS	DC	MODE	OUTDOOR		
			DEBLUR		
			INDOOR		
	MANUAL	MODE	NOMAL		
			DEBLUR		
EXPOSURE	BRIGHTNESS				0~20
	AGC				0~20
	SHUTTE R MODE	AUTO			
		MANUAL			
		FLIKERLESS			
	SHUTTE R SPEED				1/25(30), 1/50(60), 1/100(120), 1/200(250), 1/400(500), 1/800(1,000), 1/1600(2,000), 1/3200(4,000), 1/6400(8,000), 1/12800(15,000), 1/25600(30,000)
	SENS-UP				OFF, X2, X4, X8, X16, X32
WHITE B ALANCE	AWB				
	ATW				
	PUSH LOCK				
	MANUAL	COLOR TEMP.			3000K, 5000K, 8000K
		R-GAIN			0~20
		B-GAIN			0~20
BACKLIGHT	WDR	MODE	NORMAL		
			ROI	WINDO W MOD E	0~3
				WINDOW SEL	ON/OFF
				H-POS	0~1920
				V-POS	0~1080
				H-SIZE	0~1920
				V-SIZE	0~1080
		WEIGHT			LOW, MIDDLE, HIGH
	OFF				
	HLC	LEVEL			0~20
		COLOR			BLK, WHT, YEL, CYN, GRN, MAG, RED, BLU
	BLC	H-POS			0~20
		V-POS			0~20
		H-SIZE			0~20
		V-SIZE			0~20
DNR					OFF, LOW, MIDDLE, HIGH
DAY & NIGHT	AUTO	DWELL TIME			0~9 SEC
		AGC THRES			0~20
		AGC MARGIN			0~20
	COLOR				
	B&W				
	IR_EXT	DWELL TIME			0~9 SEC
		D->N LEVEL			0~20
		N->D LEVEL			0~20
		SMART IR			OFF/ON
		LEVEL			0~20

SETUP MENU	SUB MENU1	SUB MENU2	SUB MENU3	SUB MENU4	VALUE
IMAGE	SHARPNESS	SDI & CVBS			0~10
		HDC			0~10
		HDT			0~10
		HAD			0~10
	COLO R LE VEL				0~20
	MIRROR				OFF/ ON
	FLIP				OFF / ON
	GAMMA				0.45, 0.55, 0.65, 0.75
	ACE				OFF, LOW, MIDDLE, HIGH
	DEFOG	OFF			
ON		MODE		MANUAL / AUTO	
	LEVEL		LOW, MIDDLE, HIGH		
SPECIAL	COM. ADJUST	CAM ID			0~255
		BAUDRATE			2400, 4800, 9600, 19200, 38400, 57600, 115200
		PROTOCOL			PELCO-D
		SET DONE			ON
	PRIVACY	OFF			
		ON	MASK SEL		0~15
			MASK MODE		OFF / ON
			H-POS		0~60
			V-POS		0~34
			H-SIZE		0~60
			V-SIZE		0~34
			Y LEVEL		0~20
			CB LEVEL		0~20
			CR LEVEL		0~20
			TRANS		0~3
	MOTION	OFF	DET WINDOW	WINDO W SEL	0~3
		ON		WINDO W MOD E	OFF / ON
				DET H-POS	0~60
				DET V-POS	0~34
				DET H-SIZE	0~60
				DET V-SIZE	0~34
			DET TONE	0~4	
		MDRECT FILL		OFF / ON	
		SENSITIVITY		0~10	
		MOTION OSD		OFF / ON	
		TEXT ALARM		OFF / ON	
SYSTEM	VIDEO OUTPU T	MAIN OUTPU T			ANALOG OUTPUT / SDI OUTPUT
		SDI OU TPUT			** DCC-830 mode (SDI, EX-SDI, EX-SDI II) HD-SDI / 270M(V1.0) / 135M(V2.0)
		ANALO G OUT PUT			** ACC-830 mode CVBS / HDA / HDT / HDC
	FRAM RATE				720_25(30)P / 720_50(60)P / 1080_25(30)P
	FREQ(NT/PAL)				50HZ(PAL) / 60HZ(NTSC)
	LANGUAGE				ENG, CHN, CHN(S), JPN, KOR
	CAM TITLE				OFF / RIGHT UP / LEFT DOWN /
FACTOR Y DEFAU LT					Reset to factory setting
EXIT	SAVE & END				Exit SETUP menu after saving
	CANCEL				Exit SETUP menu without saving