

# AHR-RF949(-O)

## AHD2.0 OUTDOOR CAMERA

PARANTEK



### Main Features

- 1/2.8" Sony 2.9μm Pixel Progressive Starvis Color CMOS Sensor
- Approx. 2.12 Mega Pixels (Max. 1080p)
- f=4mm M/P Lens (ICR)
- 24pcs of 850nm IR LEDs
- WDR, 3D-DNR, UTC, OSD Supported
- AHD2.0 Camera
- Flexible Installation: U type swivel bracket can hold up the camera both up & down or left & right.
- Water-proof IP66 Housing



### Dimension

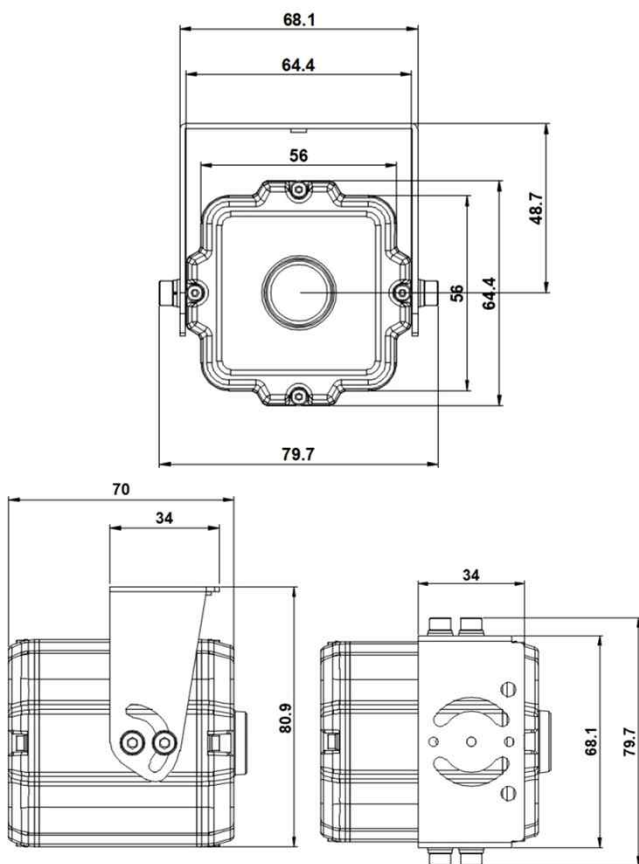

### Option

- Lens (Fixed)  
f= 2.8mm, 3.6mm, 6mm, 8mm, 12mm, 16mm, 25mm
- Dual Voltage (DC12V & AC24V)

### Specifications

Model	AHR-RF949	AHR-RF949-O
Signal System	AHD 2.0	
Pickup Device	1/2.8"(D-6.46mm) 2.12M Sony CMOS Sensor	
Scanning System	Progressive Scan (16:9 )	
Sync. System	Internal	
Total Pixels	2.16MP [1,945(H)x1,109(V)]	
Active Pixels	2.12MP [1,937(H)x1,097(V)]	
Min. Illumination	0.01Lux(F2.5 - 30IRE), 0Lux(IR on)	
No. of IRED	24pcs (850nm)	
Video Out	AHD, TVI, CVI or Analog CVBS AHD, TVI and CVI: 1080p@25/30 / Analog CVBS: D1	
Lens	f=4mm, F2.5	
Lens (Mount)	Board type (M12)	
Angle of View	92.5°(D), 78°(H), 44.5°(V)	
OSD	UTC	Via OSD Switch & UTC
Camera Title	Off, On(Max. 8 Characters)	
Language	English, Chinese(Simplified), Chinese(Traditional), Japanese, Korean	
Exposure	AE, Manual	
White Balance	AUTO, AUTOext, Preset, Manual	
BLC	Off, HLC, BLC, WDR	
Day & Night Mode	AUTO, COLOR, B/W, EXT. D&N	
Gain Control	AGC (0~10)	
Electronic Shutter	1/30(25)~1/30,000(25,600)sec (60Hz/50Hz)	
DSS(Sens-up)	X32	
Noise Reduction	3DNR (Off, Low, Middle, High)	
Mirror	Off, On(Mirror, Flip, Rotation)	
Other Features	Motion Detection (4 Zones), Privacy Mask (16 Zones), ACE, D-Zoom, Defog, Gamma, Shading etc.	
Communication	N/A	
Microphone	N/A	
Power Source	DC 12V	
Power Consumption	Less than 4.2Watts (350mA@DC12V)	
Operating Temp.	-10℃ ~ 55℃ (Humidity :0%RH ~ 90%RH)	
Size (mm)	64.4(W) x 64.4(H) x 70(D) (Without Bracket)	
Weight	400g (gift-box packing)	415g (gift-box packing)

# Cable Connection Interface

## AHR-RF949

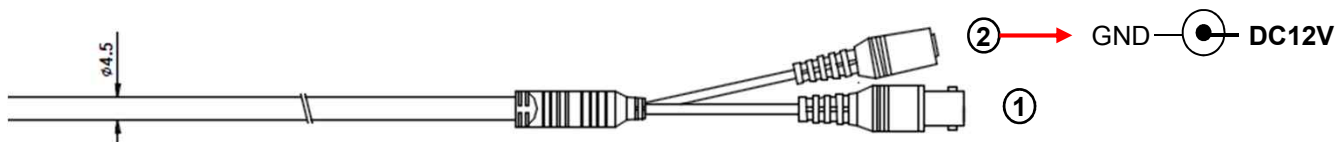

## AHR-RF949-O

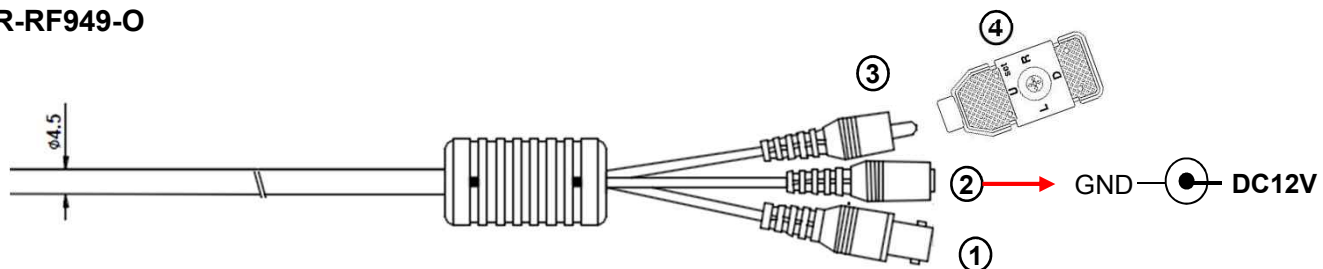

	Function		Function
①	BNC – AHD Analog Out	②	DC 3.5phi – DC Power In
③	DC 2.5phi – AD OSD port	④	AD type OSD Joystick

SETUP MENU	SUB MENU 1	SUB MENU 2	SUB MENU 3	VALUE
LENS				MANUAL / DC
EXPOSURE	BRIGHTNESS			0 ~ 20 <b>(10)</b>
	SHUTTER	AUTO	Lens Mode DC	INDOOR / <b>OUTDOOR</b> / DEBLUR
			Lens Mode Manual	<b>NORMAL</b> /DEBLUR
		MANUAL		NTSC : <b>1/30</b> ,60,120,250,500,1K,2K,4K,8K,15K,30K PAL : <b>1/25</b> ,50,100,200,400,800,1.6K,3.2K,6.4K,12.8K,25.6K
		FLICKER		
	SENS-UP			<b>OFF</b> / X2/ X4/ X8 / X16 / X32
	AGC			0 ~ 10 <b>(8)</b>
BACKLIGHT	OFF			
	HLC	LEVEL		0 ~ 20 <b>(10)</b>
		COLOR		<b>BLK</b> ,WHT,YEL,CYN,GRN,MAG,RED,BLU
	BLC	H-POS		0 ~ 20 <b>(6)</b>
		V-POS		0 ~ 20 <b>(5)</b>
		H-SIZE		0 ~ 20 <b>(7)</b>
		V-SIZE		0 ~ 20 <b>(7)</b>
	WDR	WEIGHT		LOW/ <b>MIDDLE</b> / HIGH
DAY&NIGHT	AUTO	D>N THRES		0(bright) ~ 20(dark) <b>(6)</b>
		N>D THRES		0(bright) ~ 20(dark) <b>(8)</b>
		DELAY		0 ~ 9sec, 10sec, 15sec <b>(0 Sec)</b>
		BURST		OFF/ <b>ON</b>
	COLOR			
	B&W	BURST		OFF/ <b>ON</b>
	EXT. D&N	SMART IR		<b>OFF</b> /ON
		SAT. LEVEL		0 ~ 20 <b>(10)</b>
		EXTERN SW		<b>HIGH</b> /LOW
		DELAY		0 ~ 9sec, 10sec, 15sec <b>(0sec)</b>
		BURST		OFF/ <b>ON</b>
WHITE BAL	AWB	AUTO		
		AUTOext		
		PRESET		Press ENTER key
		MANUAL	C-TEMP.	3000K/ <b>5000K</b> / 8000K
			R-GAIN	0 ~ 20 <b>(10)</b>
			B-GAIN	0 ~ 20 <b>(10)</b>
	COLOR GAIN			0 ~ 20 <b>(10)</b>
DNR				OFF/ LOW/ <b>MIDDLE</b> / HIGH
IMAGE	SHARPNESS			0 ~ 10 <b>(8)</b>
	GAMMA			0.45/ <b>0.55</b> / 0.65/ 0.75
	MIRROR			<b>OFF</b> /ON
	FLIP			<b>OFF</b> /ON
	D-ZOOM			1.0X~16.0X <b>(1.0X)</b>
	ACE			<b>OFF</b> /LOW/ MIDDLE/ HIGH

SETUP MENU	SUB MENU 1	SUB MENU 2	SUB MENU 3	VALUE
IMAGE	DEFOG	OFF		
		ON	MODE	AUTO/MANUAL
			LEVEL	LOW/ MIDDLE/ HIGH
	SHADING	OFF		
		ON	WEIGHT	0~100% (100%)
	PRIVACY	BOX	OFF/ON	
			ZONE NUM	0~15
			ZONE DISP	OFF/ON
			H-POS	0~60
			V-POS	0~34
			H-SIZE	0~60
			V-SIZE	0~34
			Y LEVEL	0~20
			CB LEVEL	0~20
			CR LEVEL	0~20
			TRANS	0~3
		POLYGON	OFF/ON	
			ZONE NUM	0~7
			ZONE DISP	OFF/ON
			POS0-X ~POS3-X	0~120
			POS0-Y~POS3-Y	0~68
			Y LEVEL	0~20
			CB LEVEL	0~20
			CR LEVEL	0~20
			TRANS	0~3
MOTION	OFF			
	ON	DET WINDOW	WINDOW USE	0~3
			WINDOW ZONE	OFF/ON
			DET H-POS	0~60
			DET V-POS	0~34
			DET H-SIZE	0~60
			DET V-SIZE	0~34
		SENSITIVITY		0~10 (5)
		MOTION OSD		OFF/ON
		TEXT ALARM		OFF/ON
		SIGNAL OUT		OFF/ON
SYSTEM	COMM	CAM ID		0 ~ 255 (1)
		BAUDRATE		2400,4800,9600,57600,115200
		CAM ID DISPLAY		OFF/ON
	OUTPUT	FREQ		50Hz(PAL) / 60Hz(NTSC)
		ANALOG MODE		OFF / CVBS / HD_T / HD_C / HD_A
		CVBS OUT MODE		CUT / FULL
	LANGUAGE			ENG/ CHINESE/ CHINESE(S)/ JAP / KOR
	CAM TITLE	OFF		
		RIGHT UP		0 ~ 9, A ~ Z, blank
		LEFT DOWN		0 ~ 9, A ~ Z, blank
FACTORY DEFAULT				Reset to factory setting
EXIT				Exit SETUP menu